

LEWMAR

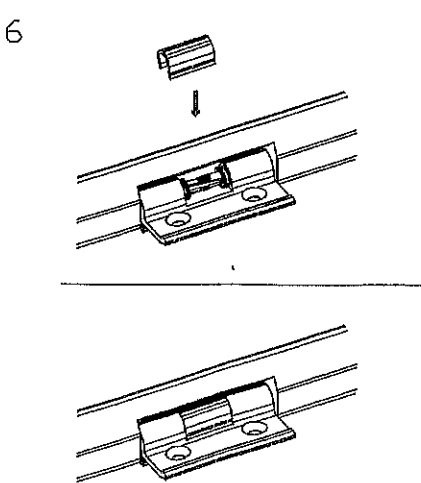
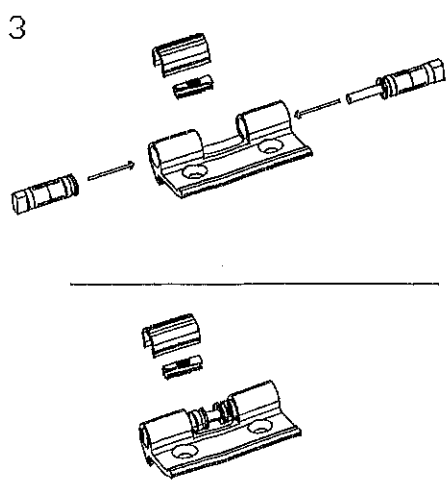
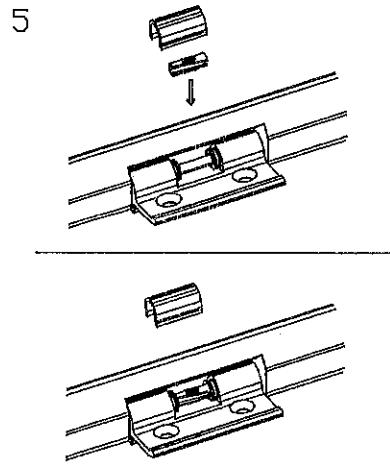
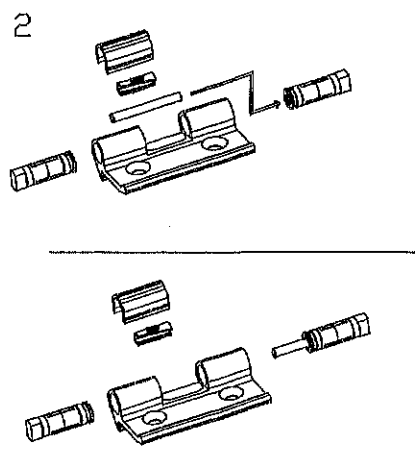
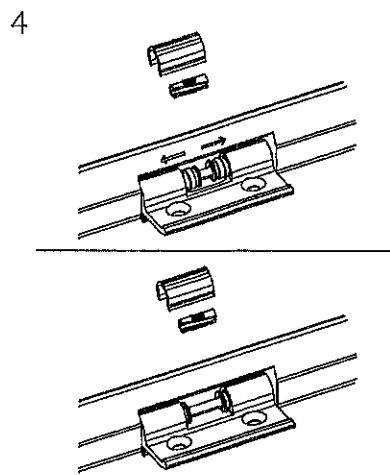
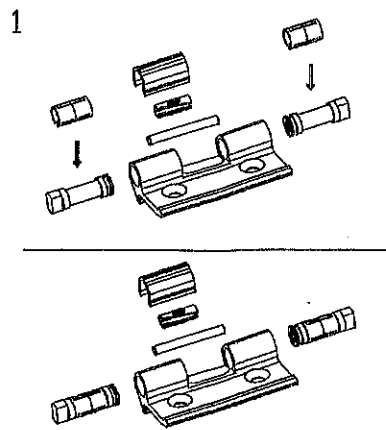

LOW & MEDIUM PROFILE

ALLOY HINGE PINS

ISSUE 1

DATE 27-JUL-01

LEWMAR®

LOW & MEDIUM PROFILE HATCHES – CHANGING HINGE PINS

2 Kits will be required for Medium Profile Size 70 and 77

This drawing shows an exploded view of the Friction Hinge assembly.

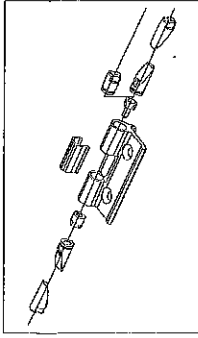

1) If the hatch is fitted with a Friction Levers detach them from the lid using a Philips head screwdriver.



2) Open the lid fully and remove the caps from the Friction Hinges. These can spring off, care should be taken not to lose them overboard.

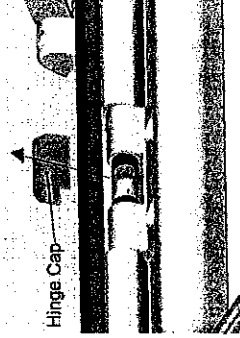

3) Use two Allen keys to turn the Jacking Screws of the Friction Hinge so that they move towards each other on their threads.

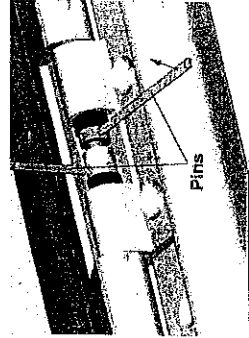

4) The jacking screws may then be removed. When the Jacking screws are re-installed, it does not matter whether the thicker or thinner part is to the center of the hatch



4) Support the lid and pull the black Friction Tapers into the middle of the Lower Hinge. This will free the lid from the base.

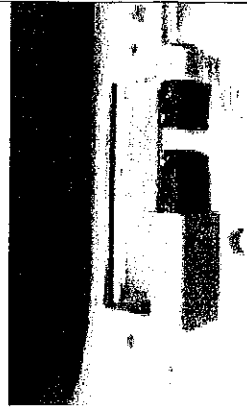

Smaller hatches have a short Friction Hinge, shown here

5) For fitting of the new alloy hinge pins see sheet 35001482-B