

INSTALLATION INSTRUCTIONS  
XEROS

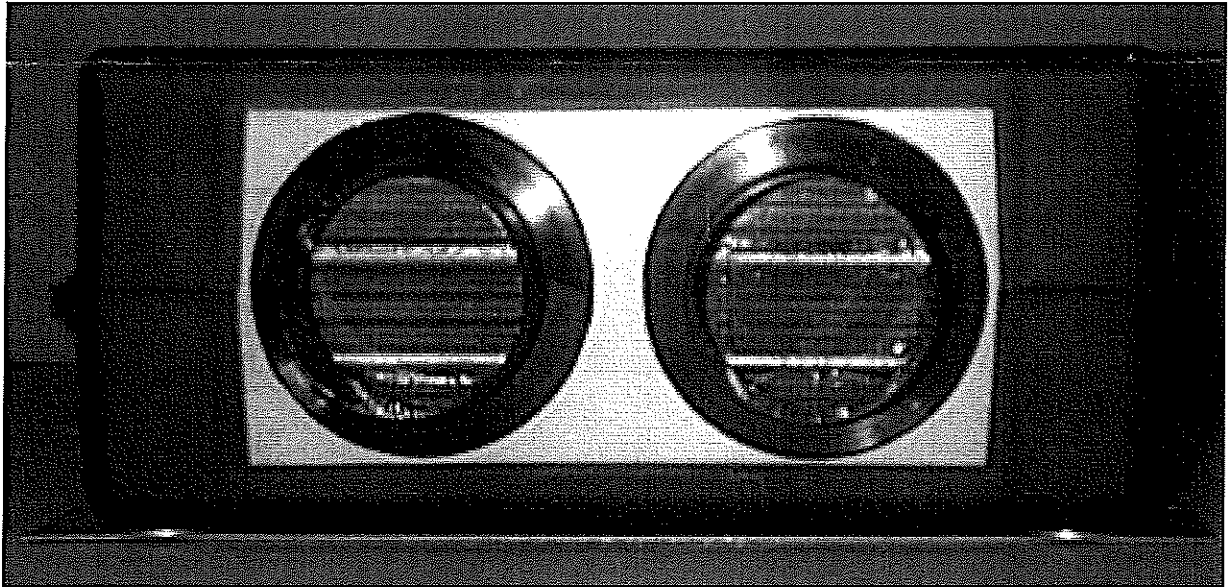

WARM AIR UNIT  
XEROS

### Technical data

The warm air unit is delivered with two connections & 60 mm for the warm air as standard.

The cover is made off plastic.

The heat coil has copper pipes and aluminium disks and designed to give the best possible heat transfer from water to air.

Maximum pressure in water circuit is 16 bar.

The fan consists in a two speed fan motor with a radial fan.

The bearings are of slide bearing type.

Heating capacity	4200W vid/at $\Delta t = 80^{\circ}\text{C}$	3000W vid/at $\Delta t = 80^{\circ}\text{C}$
Air flow	200 m <sup>3</sup> /h	150 m <sup>3</sup> /h
Electrical consumption	72W max	48W max
Voltage	12V/24V	
Weight	2.450 kg with mounting plate	
Dimensions	L= 258, B/W= 115, H= 200mm L= 285, B/W= 117, H= 250mm, with mounting plate	
Water connection	Ø 16mm	
Max water pressure	30 bars	

## Function

The heater is operated by a switch or a cabin thermostat. See separate electrical wiring diagram.

### Electrical connection

The unit is fitted with three connection cables: red, blue and black.

NOTE/ FOR FULL SAFETY USE FUSE: 12V-2A, 24V-3.15A.

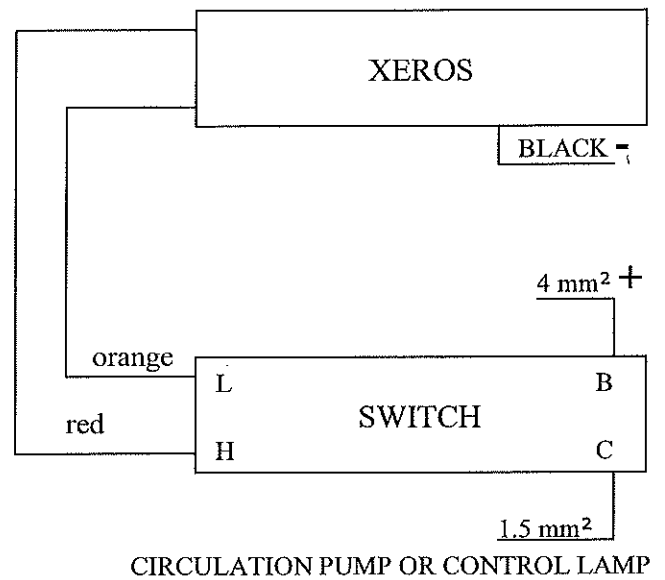
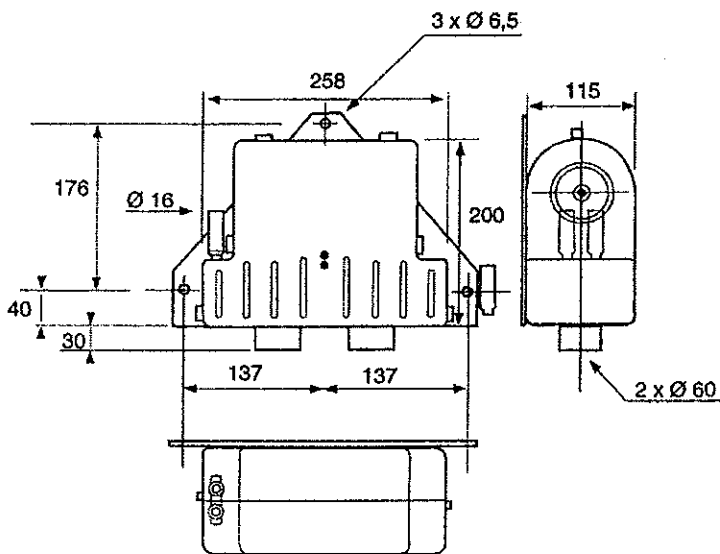

## Water connection

Warm air unit to be connected to fresh water cooled engines only.

**Reinforced rubber hoses of approved type, inner diameter 16 mm, must be used.**

For best capacity and water circulation, the warm air unit must be installed lower than the engine expansion level.

